



Product features:

- Metal construction throughout
- Single lever control for effortless single handed control
- Luscious European quality chromium plate finish
- Supplied complete with flexible tail pipes for fast simple fitting
- A modern design classic style

Packaged properties:

Box length: 255 mm **Box depth:** 95 mm
Box width: 200 mm **Boxed weight:** 2.12 kg

Includes pop up waste?: Yes

Additional comments:

Product dimensions:

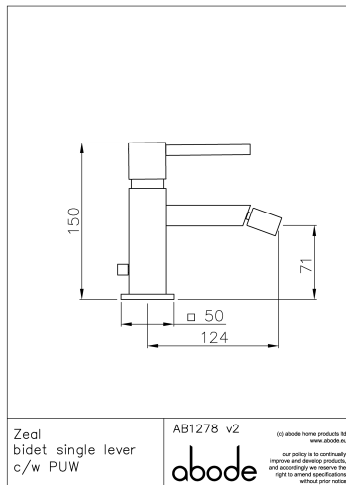

Zeal
bidet single lever
c/w PUW

AB1278 v2

abode

(c) abode home products ltd
www.abode.co.uk
our policy is to continually
improve and develop products,
and accordingly we reserve the
right to amend specifications
without prior notice.

- **Overall Height / projection:** 150 mm
- **Exit reach:** 124 mm
- **Exit height:** 71 mm
- **Centre distance(s):**

- **Base diameter(s):** 50 mm
- **Product mounted where:** Surface
- **Recommended hole diameter:** 35 mm
- **Min. fitting depth required:**
- **Max. surface depth:** 45 mm

Product flow characteristics:

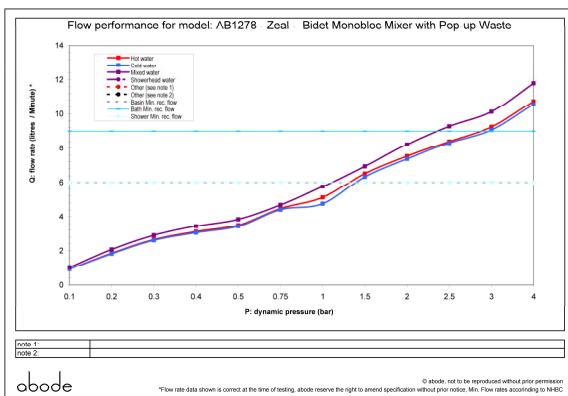

- **Min / Max water pressure:** 1 / 5.5 bar
- **Part G mixed flow rate at 3 bar (l/m):** 10.13

- **Max water temperature:** 70° C
- **Product flow characteristics:** Single flow
- **Aerator type:** Neoperl honeycomb, white screen
- **Includes output diverter?:** N/A
- **Control valve type:** Single lever (25mm)
- **Non return valve position:** n/a
- **Mesh particle filter size:**
- **Inlet / outlet size:** 1/2" F / M10
- **Inlet type / length:** Flexi / 345 mm
- **Shower hose type / length:** N/a / n/a

Warranty Summary (Full details available on request):

- Materials and workmanship defects warranted for 5 years
- Valves and working parts warranted for 5 years
- Surface warranty defects warranted for 1 year
- O-rings, hoses & gaskets warranted for 1 year

Care instructions:

- Clean the mixers and showers regularly as required, using soap, do not use any other cleaners.
- Regular cleaning will prevent the build up of lime scale and dirt
- After cleaning rinse thoroughly with clean water to remove any cleaner residue
- Residues of liquid soaps, shampoos and shower foams can also cause damage, so rinse with clean water after using, avoid contact with any abrasives