

Genio Pull out Spray

abode

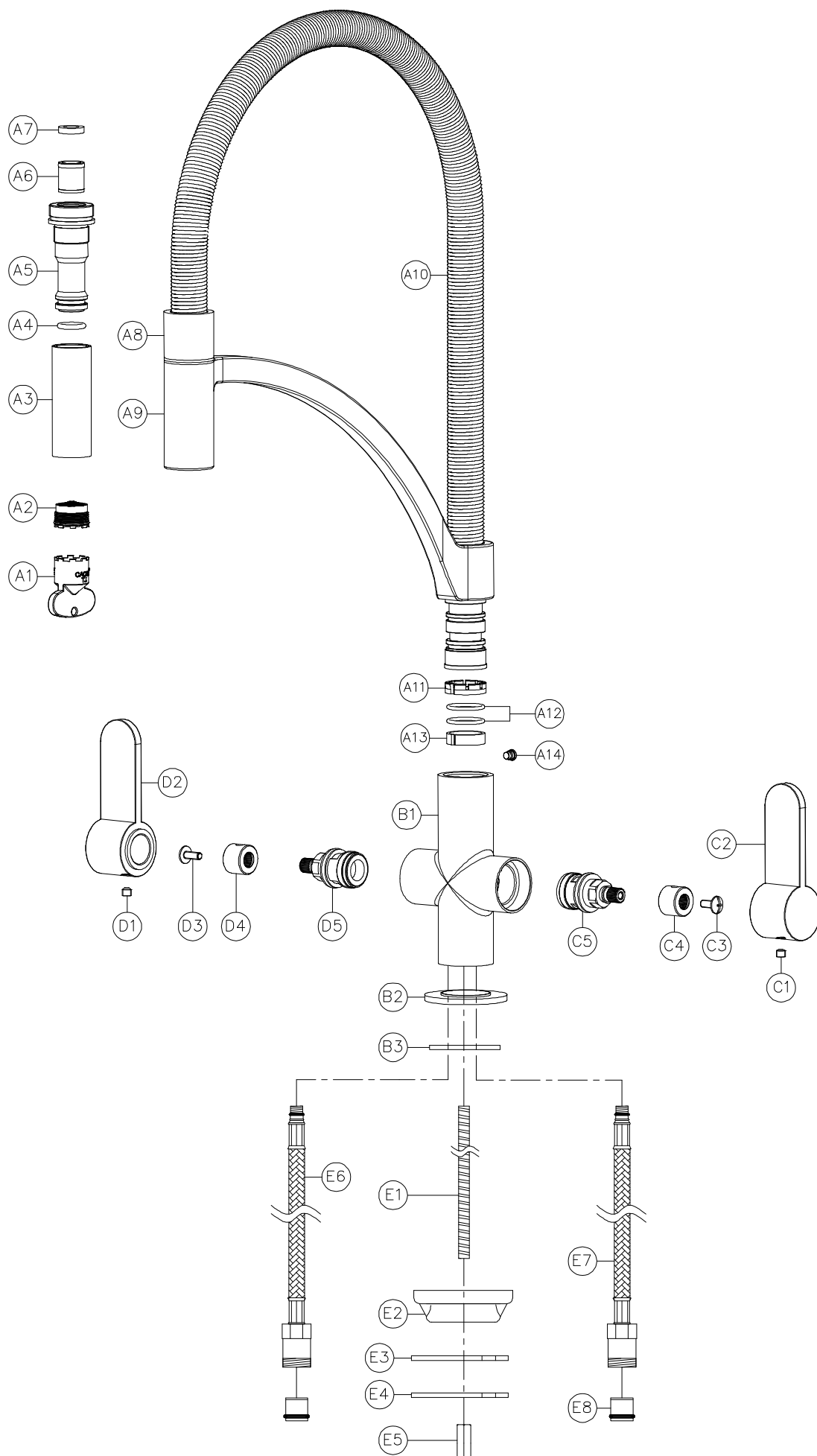

General Advice:

- These instructions are intended as a guide only, if you are in any doubt you should seek the advice of a qualified professional.
- Take care not to mark finished parts with screwdrivers or other tools.
- Use a pair of rubber gloves to get a better grip on decorative hand tight parts.
- Ensure all parts are reassembled tightly.
- After maintenance test that all assemblies are water tight and function correctly.
- Always isolate the hot and cold water supplies before starting any maintenance, once isolated you should drain any residual water from your system.

To replace the cold valve:

1. Loosen grub screw (C1) on the underside of handle (C2) using a 2.5mm A/F allen key.
2. Pull handle (C2) horizontally away from the body (B1).
3. Unscrew (C3) and pull bush (C4) away from valve (C5)
4. Using a socket unscrew valve (C5) anticlockwise.
5. Replace the faulty valve (C5) with the new one and assemble in reverse order.

To replace the spout O-rings:

1. Loosen grub screw (A14) on the rear of body (B1) using a 2.5mm A/F allen key.
2. Pull the spout (A9) vertically away from the body (B1).
3. Remove the old O-rings (A12) using a small screwdriver or similar.
4. If worn, remove the PTFE spacers (A11 & A13).
5. Ensure the inside of the body (B1) and the spout base is clean of dirt and grit with a soft wet cloth.
6. If required locate the new white PTFE spacers (A11 & A13).
7. Carefully locate the new O-rings (A12) onto the spout base (A9).
8. Grease the O-rings thoroughly with silicone or alternative similar grease.
9. Reassemble the tap in the reverse order.