

# Media single lever

abode

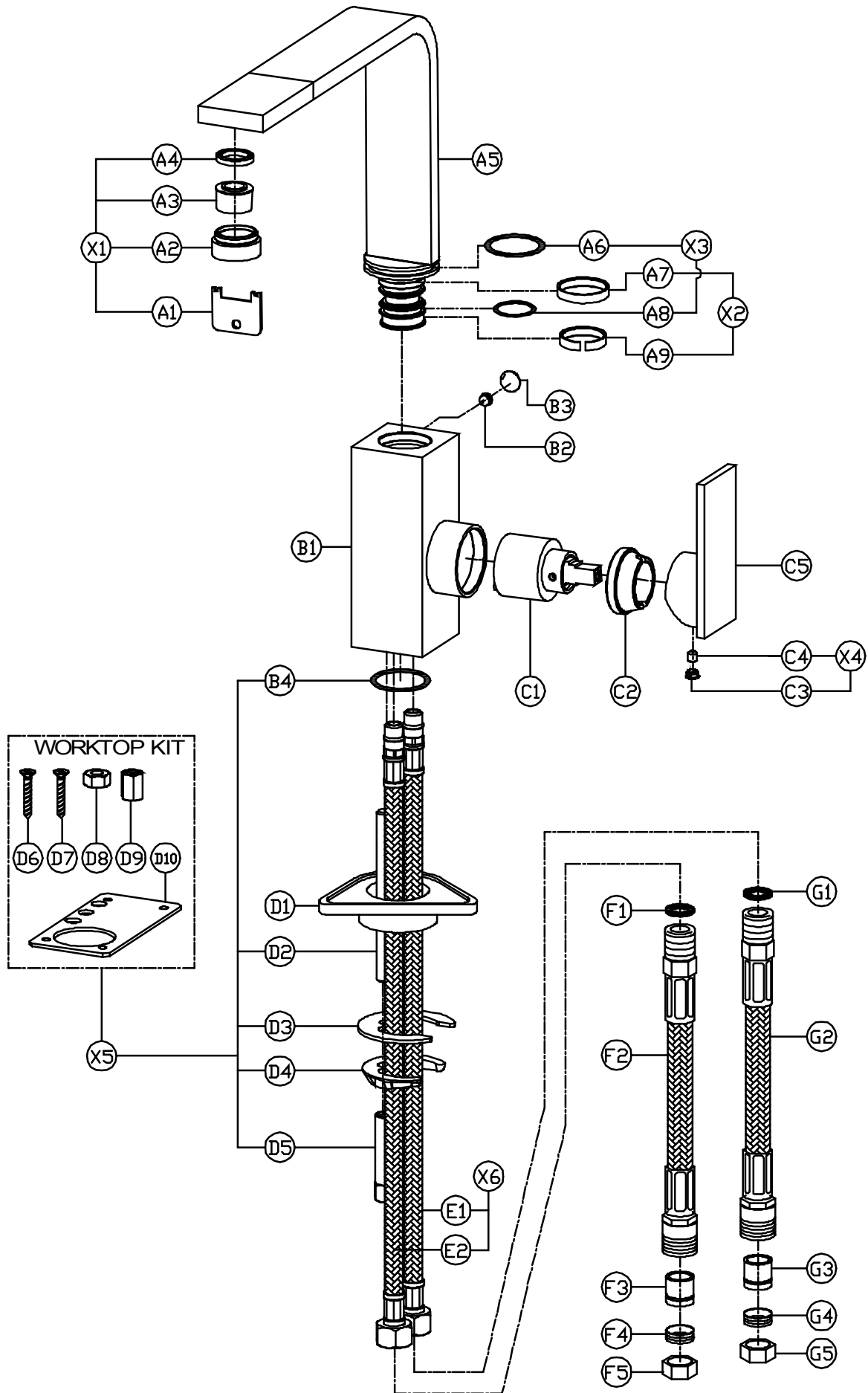

# Media single lever

## General Advice:

- These instructions are intended as a guide only, if you are in any doubt you should seek the advice of a qualified professional.
- Take care not to mark finished parts with screwdrivers or other tools.
- Use a pair of rubber gloves to get a better grip on decorative hand tight parts.
- Ensure all parts are reassembled tightly.
- After maintenance test that all assemblies are water tight and function correctly.
- Always isolate the hot and cold water supplies before starting any maintenance, once isolated you should drain any residual water from your system.

## To replace the valve:

1. Tilt the handle (C5) so dust cap (C3) is more visible.
2. Remove dust cap (C3).
3. Loosen grub screw (C4) using a 2.5mm A/F Allen key.
4. Pull the handle (C5) horizontally away from the tap body (B1).
5. Hold the body of the tap (B1) firmly. Using a suitable tool unscrew the valve lock nut (C2).
6. Pull the old valve cartridge (C1) away from the tap.
7. Ensure that the valve chamber (B1) is clean of dirt and grit.
8. Place the new valve (C1) in the chamber (B1), ensuring the locators on the base of valve (C1) align with the recesses in the chamber of the tap (B1).
9. Reassemble the tap in the reverse order.

## To replace the spout o-rings:

1. Remove dust cap (B3) from the rear of the tap using a small screwdriver.
2. Loosen grub screw (B2) using a 2.5mm A/F Allen key.
3. Pull the spout (A5) vertically away from the body (B1).
4. Remove the old o-rings (A6 & A8) using a small screwdriver or similar.
5. If worn, remove the PTFE spacers (A7 & A9).
6. Ensure the inside of the body (B1) and the spout base (A5) is clean of dirt and grit.
7. If required locate the new PTFE spacers (A7 & A9).
8. Carefully locate the new O-rings (A6 & A8) onto the spout base (C5).
9. Grease the O-rings thoroughly with silicone or alternative similar grease.
10. Reassemble the tap in the reverse order.

## To clean the aerator:

10. Hold the spout (A5) firmly.
11. Unscrew the aerator housing (A2) using the tool (A1) supplied with the tap.
12. Clean the aerator (A3).
13. Reassemble the tap in the reverse order.