

Hydrus Single lever

abode

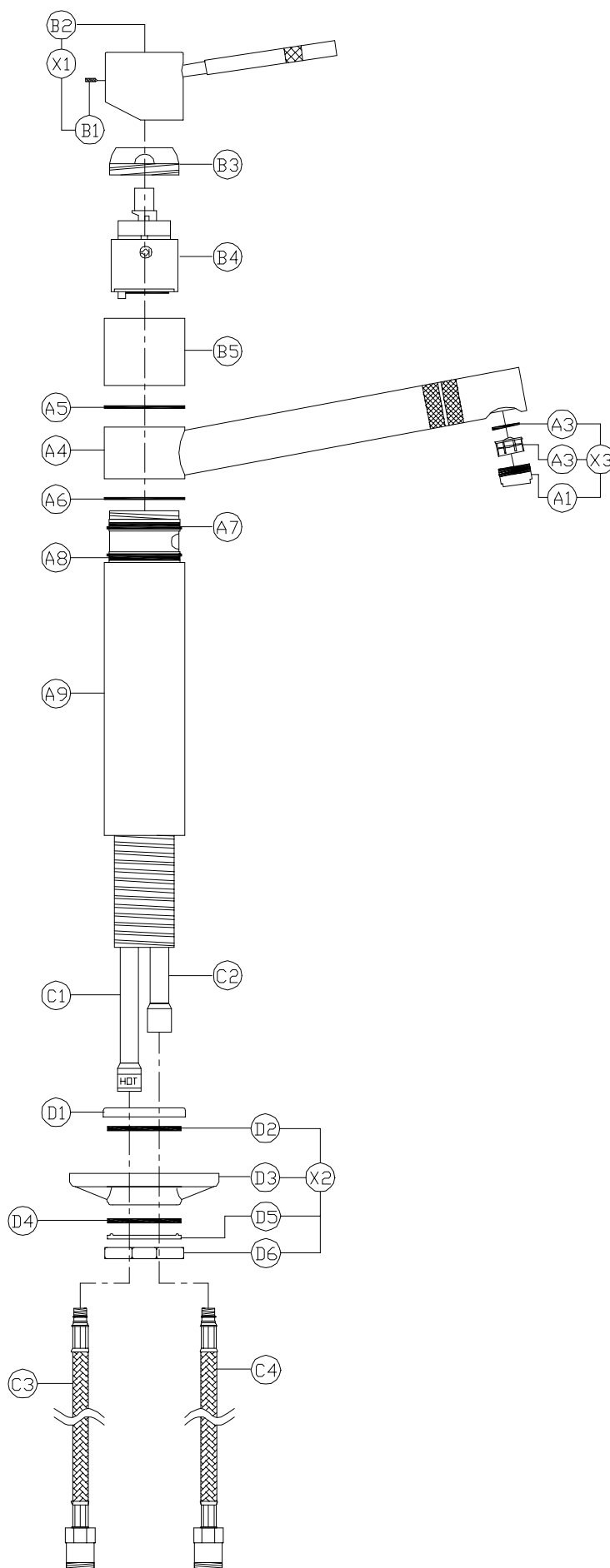

Hydrus single lever

abode

General Advice:

- These instructions are intended as a guide only, if you are in any doubt you should seek the advice of a qualified professional.
- Take care not to mark finished parts with screwdrivers or other tools.
- Use a pair of rubber gloves to get a better grip on decorative hand tight parts.
- Ensure all parts are reassembled tightly.
- After maintenance test that all assemblies are water tight and function correctly.
- Always isolate the hot and cold water supplies before starting any maintenance, once isolated you should drain any residual water from your system.

To replace the valve:

1. Tilt the handle (B2) into the on position.
2. Loosen grub screw (B1) using a 2mm A/F Allen key.
3. Pull the handle (X1) vertically away from the tap.
4. Hold the body of the tap (B5) firmly. Using an adjustable spanner unscrew the valve lock nut (B3).
5. Pull the old valve cartridge (B4) away from the tap.
6. Ensure that the valve chamber (B5) is clean of dirt and grit.
7. Place the new valve (B4) in the chamber (B5), ensuring the locators on the base of valve (B4) align with the recesses in the chamber of the tap (B5).
8. Tighten sections (B5) and (A9) against each other to ensure the body assembly has not become loosen whilst servicing the valve.
9. Reassemble the tap in the reverse order.

Note: for older versions of this tap the grub screw (B1) to remove the handle is under the lever section of the handle which must be unscrewed first.

To replace the spout o-rings:

1. Tilt the handle (B2) into the on position.
2. Loosen grub screw (B1) using a 2mm A/F Allen key.
3. Pull the handle (X1) vertically away from the tap.
4. Hold the body of the tap (B5) firmly. Using an adjustable spanner unscrew the valve lock nut (B3).
5. Pull the valve cartridge (B4) away from the tap.
6. Whilst firmly holding section (A9) unscrew section (B5).
7. Pull the spout (A4) vertically away from the body (A9).
8. Remove the old o-rings (A7 & A8) using a small screwdriver or similar.
9. If worn, remove the white PTFE spacer (A5 & A6).
10. Ensure the inside of the body (A9) and the spout inner (A4) is clean of dirt and grit.
11. If required locate the new white PTFE spacer (A6).
12. Carefully locate the new O-rings (A7 & A8) onto the body (A9)
13. Grease the O-rings thoroughly with silicone or alternative similar grease.
14. Push the spout (A4) vertically onto the body (A9).
15. If required locate the new white PTFE spacer (A5).
16. Reassemble the top section of the tap in the reverse order.

Note: section (B5) is factory fixed with a semi permanent thread lock, loosening this part will require a good grip and effort.