

Corvus Single lever

abode

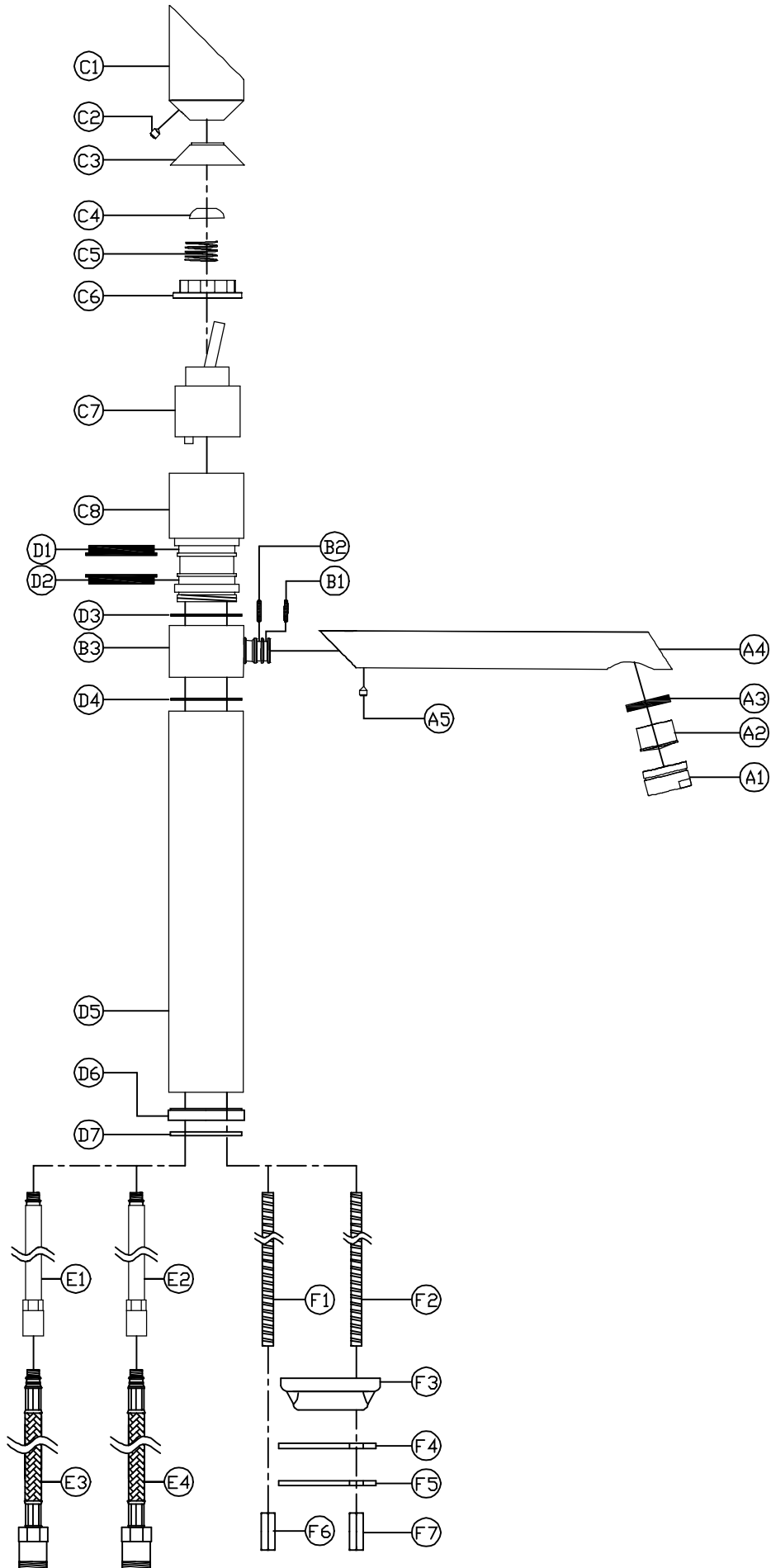

Corvus Single lever

abode

General Advice:

- These instructions are intended as a guide only, if you are in any doubt you should seek the advice of a qualified professional.
- Take care not to mark finished parts with screwdrivers or other tools.
- Use a pair of rubber gloves to get a better grip on decorative hand tight parts.
- Ensure all parts are reassembled tightly.
- After maintenance test that all assemblies are water tight and function correctly.
- Always isolate the hot and cold water supplies before starting any maintenance, once isolated you should drain any residual water from your system.

To replace the valve:

1. Loosen the grub screw (C2) at the rear of the handle (C1) using an 2mm A/FAllen key.
2. Pull the handle (C1) vertically away from the tap.
3. Pull the decorative shroud (C3) away from the body (C7), the shroud (C3) might require a small screwdriver to lever it. Take care not to lose the cap (C4) and spring (C5), place the plug in the sink if necessary.
4. Hold the tap body firmly (C8) and unscrew the brass valve locking nut (C6) using an adjustable spanner.
5. Remove the old valve cartridge (C7).
6. Clean any debris from the chamber (C8).
7. Locate the new valve (C7) into the chamber (C8); ensure the pegs on the valve align with the recess in the chamber (C8).
8. Reassemble the tap in the reverse order, if supplied replace the locking nut (C6).

Note. Take care not to loosen the body sections (D5 & C7), check both parts are assembled tightly before reassembling the valve locking nut (C6).

To replace the spout o-rings:

1. Disconnect tail pipes (E3 & E4) from the inlet legs (E1 & E2).
2. Remove fixing nuts (F6 & F7).
3. Pull the tap away from the sink.
4. Holding section (C8) unscrew section (D5).
5. Pull the spout base (B3) down away from the upper section (C8).
6. Remove the old o-rings (D1 & D2) using a small screwdriver or similar, note the orientation of the o-rings for reassembly.
7. Reassemble the top section of the tap in the reverse order ensuring the white PTFE spacers (D3 & D4) are placed above and below the spout.

Note: Ensure both body sections (D5 & C7) are assembled tightly when reassembling the tap.