

Atlas 4 Part mixer

abode

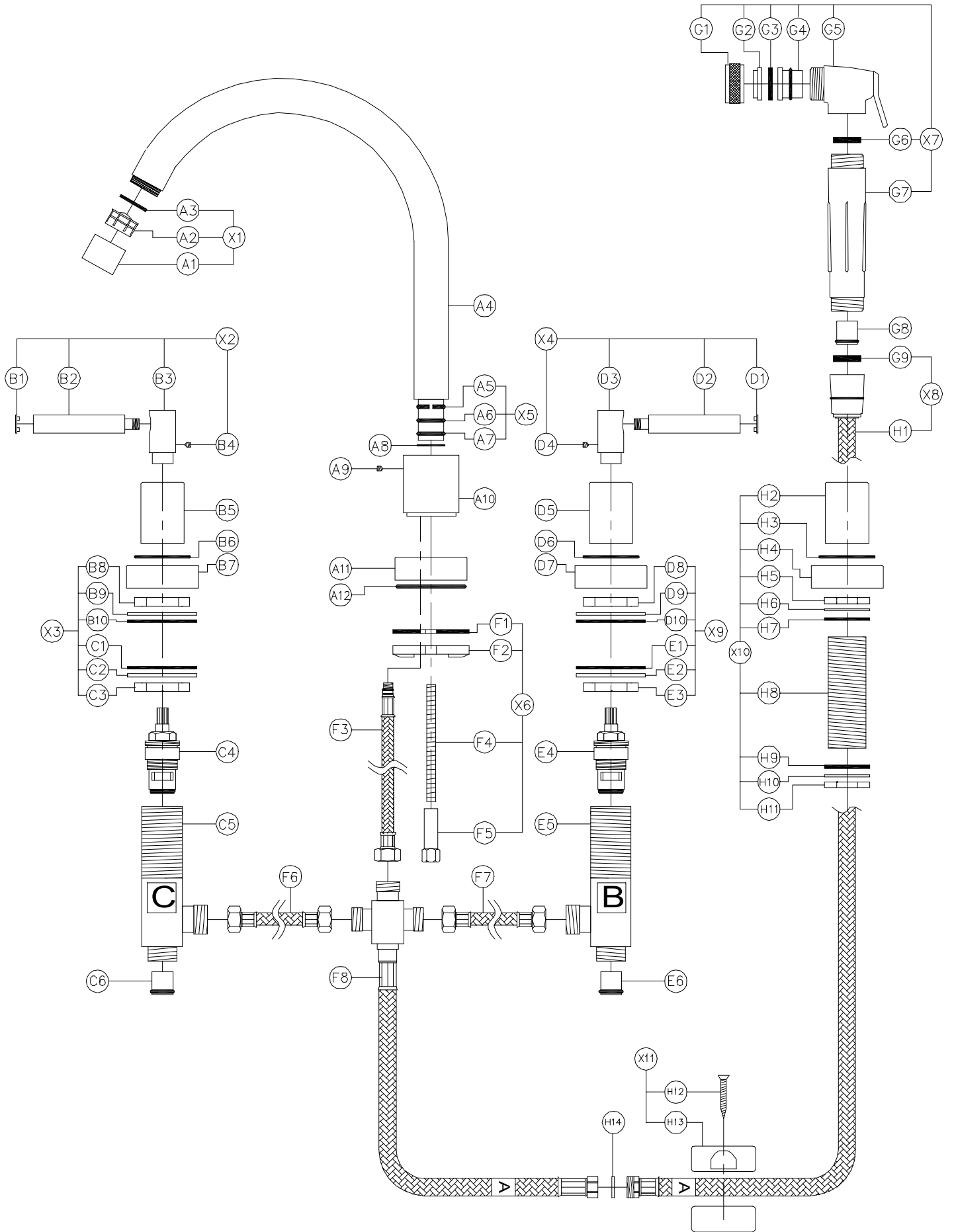

Atlas 4 Part mixer

abode

General Advice:

- These instructions are intended as a guide only, if you are in any doubt you should seek the advice of a qualified professional.
- Take care not to mark finished parts with screwdrivers or other tools.
- Use a pair of rubber gloves to get a better grip on decorative hand tight parts.
- Ensure all parts are reassembled tightly.
- After maintenance test that all assemblies are water tight and function correctly.
- Always isolate the hot and cold water supplies before starting any maintenance, once isolated you should drain any residual water from your system.

To replace the spray head (if leaking from (G1) or damaged):

1. Hold the barrel of the hand spray (G7).
2. Unscrew the chrome nut (H1).
3. Reassemble the tap in the reverse order.

If spray trigger (G5) is stiff or locks:

1. Hold the barrel of the hand spray (G7).
2. Unscrew the chrome nut (H1).
3. hold spray head (G5) and unscrew barrel (G7)
4. Using a screwdriver or similar push the white non return (G8) valve out of the barrel (G7).
5. Reassemble the tap in the reverse order.

To replace the spout o-rings:

1. Loosen grub screw (A9) using a 2mm A/F Allen key.
2. Pull the spout (A4) vertically away from the body (A10).
3. Remove the old o-rings (A6 & A7) using a small screwdriver or similar.
4. If worn, remove the white PTFE spacer (A5).
5. Ensure the inside of the body (A10) and the spout base (A4) is clean of dirt and grit.
6. If required locate the new white PTFE spacer (A5).
7. Carefully locate the new O-rings (A6 & A7) onto the spout (A4).
8. Grease the O-rings thoroughly with silicone or alternative similar grease.
9. Reassemble the tap in the reverse order.

To replace the hot water valve:

1. Using a 2mm A/F Allen key loosen the grub screw (B4) at the base of the handle (B4).
2. Pull the handle (X2) vertically away from the valve (C4).
3. Unscrew the decorative cover (B5) anticlockwise.
4. Unscrew the valve (C4) using a 17mm ring or adjustable spanner.
5. Clean any debris from the chamber in the tap body (C5).
6. Reassemble the tap in the reverse order using the new valve.

To use the spray rinse for cold water only (independently of the spout):

1. Remove the 4 way tee and hose (F8).
2. Replace the 4 way tee with a standard 3 way 1/2" tee, connecting the hot and cold supplies to the spout.
3. Connect the spray hose (H1) to the 15mm x 1/2" hose supplied, include rubber seal (H14) between the hoses.
4. Connect another 3 way tee to the cold water supply before the tap.
5. Connect the new 1/2" hose to the new 3 way tee on the cold supply.
6. Hold the barrel of the hand spray (G7). Unscrew the chrome nut (H1). Hold spray head (G5) and unscrew barrel (G7). Using a screwdriver or similar push the white non return (G8) valve out of the barrel (G7). Reassemble the spray head in the reverse order.
7. in high pressure installations the spray head trigger may be stiff to operate, in this instance install a 1-2 bar pressure reducing valve after the cold water branch to the spray head.

